

MODEL CASE

MODEL CASE

Oyster, 40 mm, steel

DIAMETER

40 mm

MATERIAL

904L steel

BEZEL

Smooth

WINDING CROWN

Screw-down, Twinlock double waterproofness system

CRYSTAL

Scratch-resistant sapphire

WATER-RESISTANCE

Waterproof to 50 metres

MOVEMENT

MOVEMENT

Perpetual, mechanical, self-winding, with a magnetic shield to protect the movement

CALIBRE

3131, Manufacture Rolex

FUNCTIONS

Centre hour, minute and seconds hands. Stop seconds for precise time setting

OSCILLATOR

Paramagnetic blue Parachrom hairspring

WINDING

Bidirectional self-winding via Perpetual rotor

POWER RESERVE

Approximately 48 hours

BRACELET

BRACELET

Oyster, flat three-piece links

BRACELET MATERIAL

904L steel

CLASP

Folding Oysterclasp with Easylink 5 mm confort extension link

OVERVIEW

- 1 Hour hand
- 2 Minute hand
- 3 Seconds hand
- 4 Twinlock winding crown

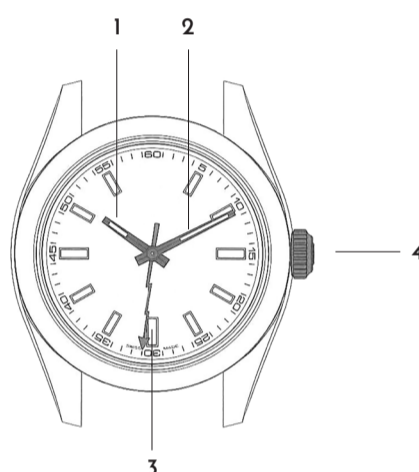

SETTING THE OYSTER PERPETUAL MILGAUSS

Screwed-down position (crown in position 0):

the crown is completely screwed down against the case.

When the crown is in this position, the Oyster Perpetual Milgauss is guaranteed waterproof to a depth of 50 metres

Manual winding (position 1):

the crown is unscrewed. To wind the watch manually, turn the crown clockwise; turning in the other direction has no effect. When setting the watch for the first time or after the watch has stopped, complete a minimum of 20 turns for partial winding

Setting the time (position 2):

the crown is unscrewed and pulled out to the first notch. The seconds hand is stopped, allowing you to set the time to the precise second. To set the hour and minute, turn the crown in either direction.

Initial winding and setting:

- A. Wind the watch manually (position 1).
- B. Set the time (position 2).



To screw the crown back down against the case, return it to position 1 and apply light pressure on it while screwing it down clockwise against the case.

After every use, carefully screw the crown back down against the case to guarantee the waterproofness. The crown should never be unscrewed under water

ADJUSTING FROM THE SHORT POSITION TO THE LONG POSITION

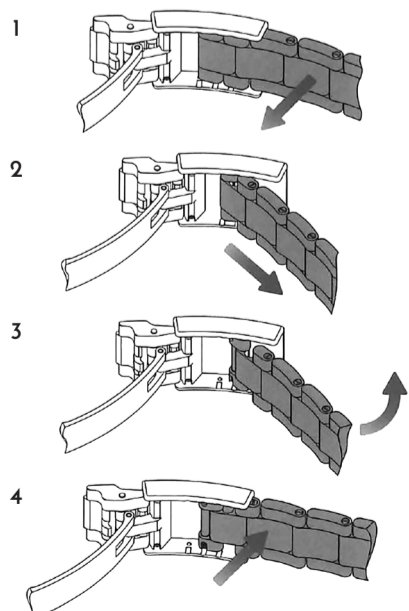

ADJUSTING FROM THE LONG POSITION TO THE SHORT POSITION

